

Switchcraft®

[Previous Page](#) | [Return to Index](#) | [Next Page](#)



3502RABAU



3502RAAU



3502RA

Right Angle Phono Plug

Switchcraft's right-angle phono plugs (3502RA) features an easy-to-assemble three piece construction: a handle, insulator and plug assembly. The plug features a solid-pin design and large solder terminals that make termination faster and easier. The reduced profile makes it perfect for use behind equipment where space is at a premium. The larger cable clamp and handle will accommodate a variety of cable sizes. Available in nickel or gold-plated plug bodies with nickel or black finish handles, this new phono plug will save time and space in any application.

Features and Benefits

- Solid center conductor
- High quality appearance
- Larger cable clamp provides better strain relief for large cables
- Longer cable clamp for easier plug assembly and more room for solder connection
- Knurl on the back of handle provides ergonomic gripping surface to tighten plug
- Longer handle for improved gripping surface and easy plug withdrawal from jack

Markets

- Audio

- Consumer electronic equipment
- Broadcast studios
- Home recording equipment
- Audio cable assembly manufacturers
- Instrumentation
- Test equipment

Part Number Description

- **3502RA** has nickel-plated plug finger and handle
- **3502RAAU** has gold-plated plug finger and nickel-plated handle
- **3502RABAU** has gold-plated plug finger and black epoxy finished handle

Download Product Bulletin Pages	
	<ul style="list-style-type: none">● NPB 534-Page 1: General info and photos● NPB 534-Page 2: Specifications & drawings

[Previous Page](#) | [Return to Index](#) | [Next Page](#)

| [Switchcraft home](#) |
[About Us](#) | [Products](#) | [What's New](#) | [Search](#) | [Contact Us](#)

Right Angle Phono Plug 3502RA Series

Specifications

Electrical

Contact Resistance (typical *D.O.M.J.): <0.20 ohms
 Dielectric Withstand Voltage: 500VAC (minimum)
 Insulation Resistance @ 500VDC: 2,000 megohms (minimum)
 Insulation Resistance (after MIL-STD-202 Salt Spray):
 1,000 megohms (minimum)
 Working Voltage: 250VAC, 140VDC
 Current Carry @ Working Voltage (typical *D.O.M.J.):
 6.0 Amps

Mechanical

Insert/Withdrawal Force: *D.O.M.J.
 Temperature Range: -40°C to +85°C
 U.L. Component Recognition File No.: E118169
 Life: *D.O.M.J.
 Maximum Cable Size: .285" diameter

**D.O.M.J. - Dependent On Mating Jack*

Material

Pin: Copper alloy, nickel-plated or gold-plated
 Sleeve: Copper alloy, nickel-plated or gold-plated
 Handle: Copper alloy, nickel-plated or black epoxy finished
 Cable Clamp: C.R.S., electrotin-plated
 Insulator: Rigid plastic

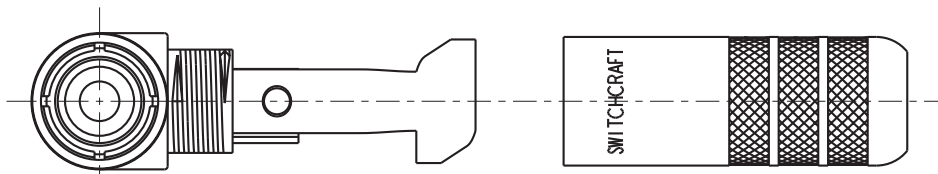
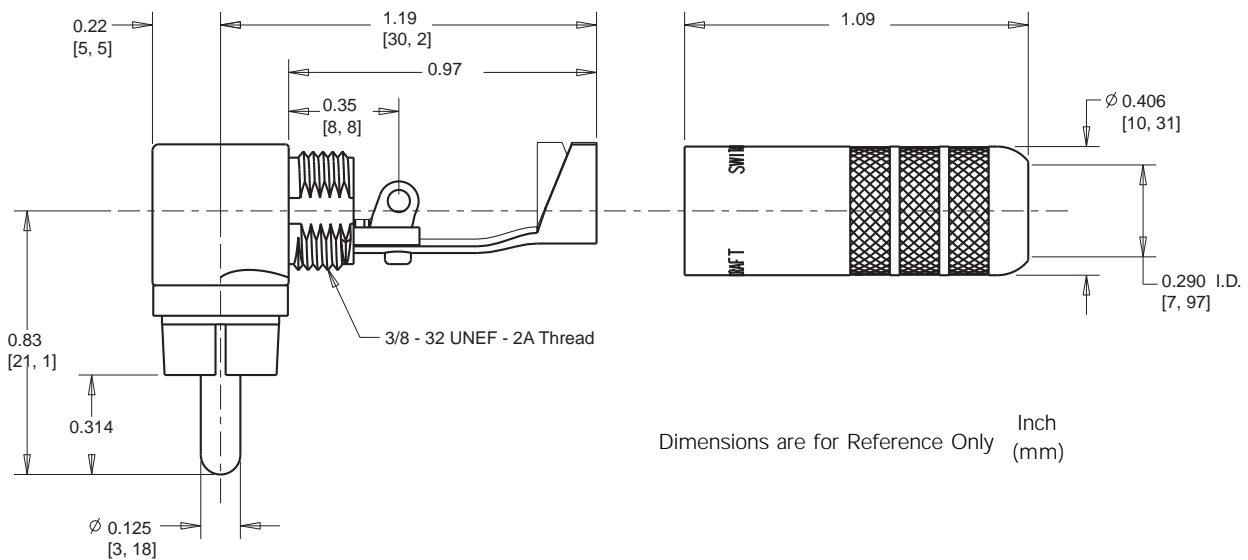

JACKS & PLUGS

PRODUCT BULLETIN 534

RIGHT ANGLE PHONO PLUG

Switchcraft's right-angle phono plugs (3502RA) features an easy-to-assemble three piece construction: a handle, insulator and plug assembly. The plug features a solid-pin design and large solder terminals that make termination faster and easier. The reduced profile makes it perfect for use behind equipment where space is at a premium. The larger cable clamp and handle will accommodate a variety of cable sizes. Available in nickel or gold-plated plug bodies with nickel or black finish handles, this new phono plug will save time and space in any application.

Features and Benefits

- Solid center conductor
- High quality appearance
- Larger cable clamp provides better strain relief for larger cables
- Longer cable clamp for easier plug assembly and more room for solder connection
- Knurl on the back of handle provides ergonomic gripping surface to tighten plug
- Longer handle for improved gripping surface and easy plug withdrawal from jack

Markets

- Audio
- Consumer electronic equipment
- Broadcast studios
- Home recording equipment
- Audio cable assembly manufacturers
- Instrumentation
- Test equipment

Part Number	Description
3502RA	Nickel-plated plug finger and handle
3502RAAU	Gold-plated plug finger and nickel-plated handle
3502RABAU	Gold-plated plug finger and black epoxy finished handle



Part # 3502RABAU



Part # 3502RAAU



Part # 3502RA